

Read these instructions before installation and retain for future reference. This equipment should be installed by a competent electrician 

Important Information

We recommend that luminaires are installed by a qualified electrician ensuring the installation complies with current IEE wiring regulations BS7671:2018 & local building control.

- All tests should be carried out in accordance to EN 50172:2004.
- BELL will not accept responsibility for any claims arising from a poor installation.
- Not suitable for petrochemical installations.
- Upgrading of MCB may be necessary
- Operating Temperature -30°C to +35°C, emergency versions 0°C to +35°C
- You are advised to test 5 samples before mass application of sensor in a new lighting project. The distance between any inductive sensors should be greater than 3m.
- Microwave maximum operating height 3.2m
- IK10r

Warning Before installation ensure power is disconnected.

This luminaire contains a light source of energy rating E

This product may contain substances that can be hazardous to the environment if not disposed of properly. Electrical and electronic equipment should never be disposed of with general household waste but must be separated for its correct treatment and recovery.

Where possible recycle your packaging.

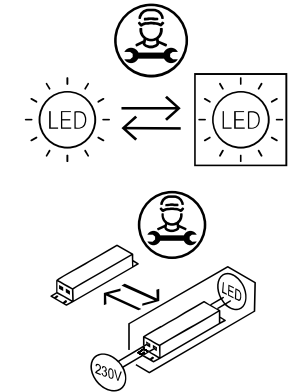
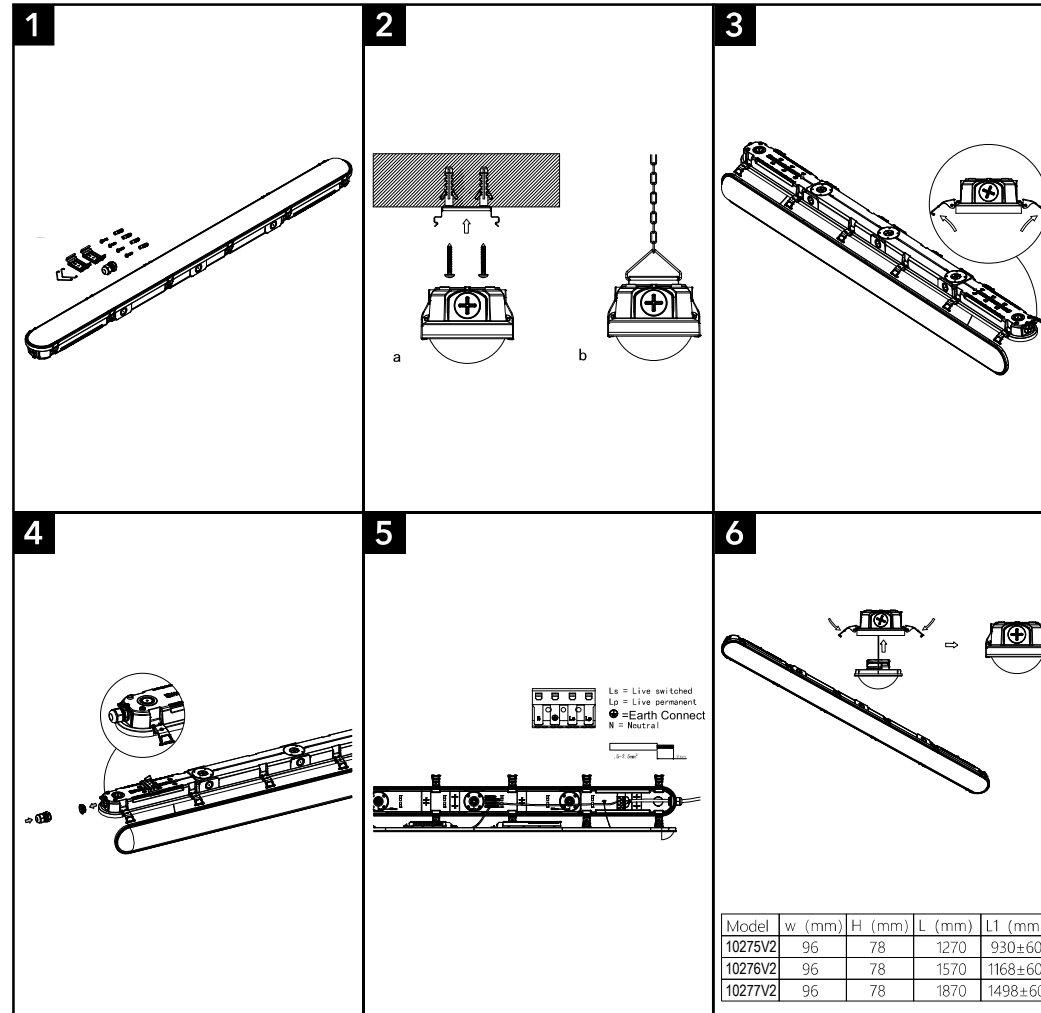

Read these instructions before installation and retain for future reference. This equipment should be installed by a competent electrician



Colour Temperature

